

Swing Lever Hose Kit

CATEGORY: Advised At Next Maintenance

SUMMARY: The replacement Swing Lever Hose Kit development has been introduced by CarnaudMetalbox Engineering as an improvement to the former hose kit design. The new design ensures that the hose itself does not travel a great distance with the Swing Lever hence placing it under less strain. Therefore the entire system will prove far more reliable in terms of likelihood of the hose breaking.

The improved 'life expectancy', and consequently the improved time between the need for a system replacement. This new development is available to B series Bodymakers fitted with heavy weight steel, lightweight steel or carbon fibre Swing Levers where it has not already been installed.

An estimation of the time scale for a complete retrofit is six hours, with all the items needed for the upgrade supplied in the form of a retrofit package.

For further information about the new swing lever hose kit, please contact either of the references detailed below, quoting the technical bulletin number **TB-B3/B4-001**.

Note: When ordering please specify Swing Lever type and machine stroke.

Note: A complete Library of Technical Bulletins is accessible on the Company Web Site.

Former Hose Routing

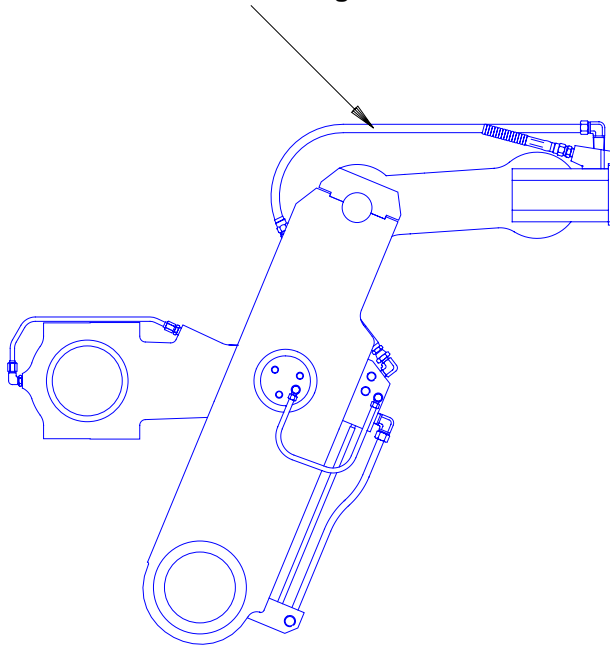

Superseded Design of Hose Kit for Lightweight Steel Swing Lever Shown

New Routing of Hose Kit

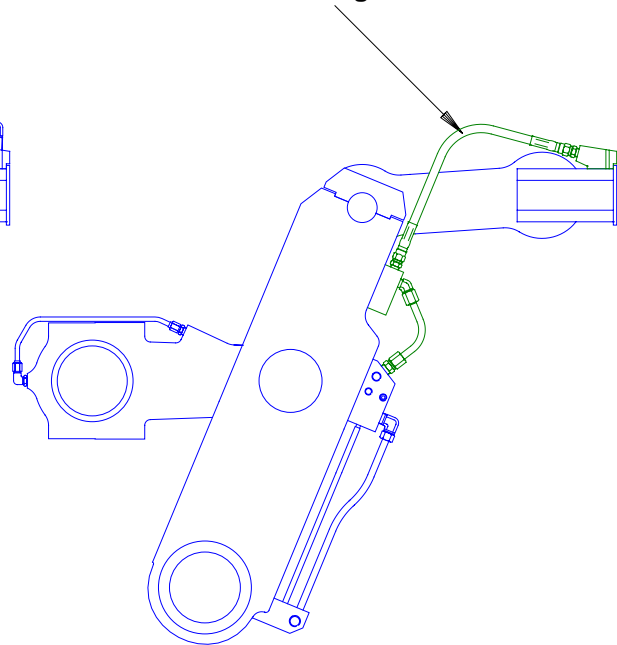

Improved Design of Hose Kit for Lightweight Steel Swing Lever Shown

Adrian Long,
CarnaudMetalbox Engineering Plc,
Dockfield Road, Shipley,
West Yorkshire, BD17 7AY, UK
Tel: +44 1274 846208, Fax: +44 1274 846201
email: adrian.long@eur.crowncork.com

Paul J Orsino III,
CarnaudMetalbox Engineering Plc,
79 Rockland Road, Norwalk,
Connecticut 06854, USA
Tel: +1 203 853 7325, Fax: +1 203 866 7627
email: porsino@crowncork.com