

Rotary Manifold

CATEGORY: Information for Factory Implementation

Summary: Continued reliability of the 3400 System will depend upon careful maintenance of the machine components. Experience with this machine has established that the Shoe in the Rotary Manifold requires checking every six months for wear.

Check using micrometers the dimensions at the points shown (illustration refers) and If more than a 1mm taper is noted then it is necessary to re face the areas shown, maintaining the dimensions illustrated below.

Re facing can be done until a minimum 22mm service limit is attained.

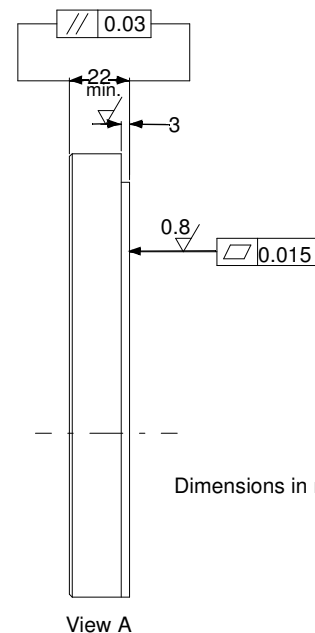
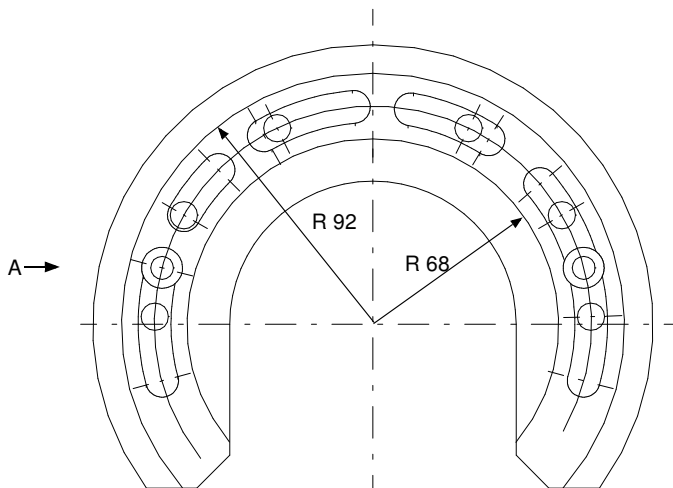
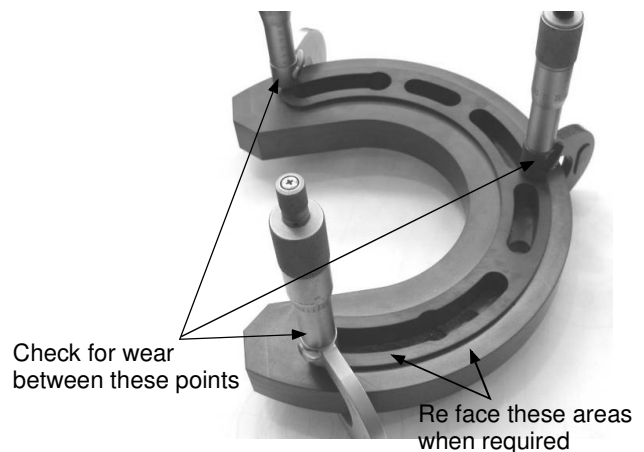

Dimensions in millimetres

For further information regarding this Technical Bulletin please contact either of the contacts below quoting Technical Bulletin Number **TB3400-005**

Note: a complete Library of Technical Bulletins is accessible on the Company Web Site.

CarnaudMetalbox Engineering Limited,
 Dockfield Road, Shipley,
 West Yorkshire, BD17 7AY, UK
 Tel: +44 1274 846200, Fax: +44 1274 846201
 email: sales@CMBEcanmaking.com

CarnaudMetalbox Engineering Limited,
 79 Rockland Road, Norwalk,
 Connecticut 06854, USA
 Tel: +1 203 853 7325, Fax: +1 203 866 7627
 email: sales@CMBEcanmaking.com